

Let's Go.

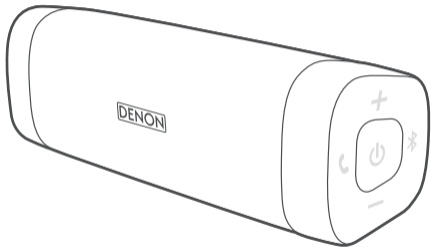

Get to Know

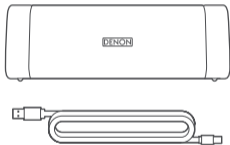

1

Call answer
/end button

2

Power

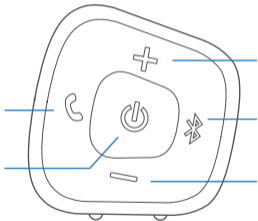

3

Volume up

4

Bluetooth®
pairing button

5

Volume down

1

Anruftaste

Touche d'appel

Pulsante di chiamata

Botón de llamada

Gesprekstoets

Samtalsknapp

Кнопка вызова

Przycisk połączenia

コールボタン

通话按钮

2

Ein-/Aus-Schalter

Alimentation

Accensione

Alimentación

Voeding

Ström

Питание

Zasilanie

電源ボタン

电源

3

Lautstärke hoch

Augmenter le volume

Volume su

Subir volumen

Volume hoger

Volym upp

Повысить громкость

Zwiększenie głośności

音量プラスボタン

音量增大

4

Bluetooth®-Taste

Touche Bluetooth®

Pulsante Bluetooth®

Botón de Bluetooth®

Bluetooth®-toets

Bluetooth®-knapp

Кнопка Bluetooth®

Przycisk Bluetooth®

Bluetooth®ボタン

蓝牙按钮

5

Lautstärke runter

Diminuer le volume

Volume giù

Bajar volumen

Volume lager

Volym ned

Понизить громкость

Zmniejszenie głośności

音量マイナスボタン

音量减小

Charge

1. Open cap on the rear side.
2. Connect the USB cable to the speaker and USB power adapter* via an AC outlet or computer.

NOTE

*USB power adapter not included. Rating of adapter should be less than DC 5 V, 2.4 A. Must be used with country specific approved adapter.

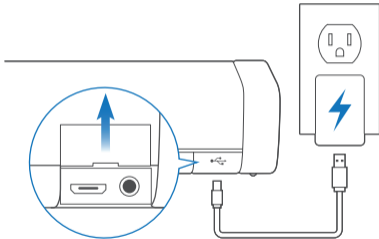

Connect

1. Power on.
2. Activate Bluetooth settings on your mobile device. Select “**Denon Envaya.**”
3. After you hear a 3 note tone, the indicator light stops blinking and turns solid, you are connected.
4. To connect an additional device, press the “Bluetooth button”, and activate Bluetooth settings on your mobile device.



Talk + Siri Play*

1. To answer and end calls, tap the “call answer/end button”.**
2. To activate Siri Play, confirm that your iPhone is paired.
Press and hold the “call answer/end button” for 3 or more seconds.
3. Siri is automatically activated and your speaker will answer your voice commands.

NOTE

*For iPhone only.

**Not all mobile phones and apps support hands-free phone calling.



Envaya Link

1. Once your mobile device is paired with the master speaker, power on the second speaker.
2. Press and hold the "Bluetooth pairing button" on the master speaker and slave speaker simultaneously for 6 or more seconds.
3. Once you hear a beep, the pairing of the two speakers is complete.

NOTE

*Stereo pairing allows A2DP audio to be forwarded between your device so that the audio is played in sync on both devices.

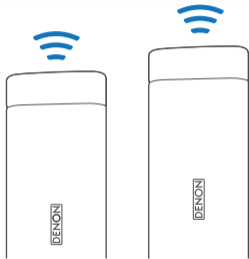

DENON[®]

www.denon.com

Online Manual: http://manuals.denon.com/DSB50_150_250BT/ALL/EN
iPhone and Siri are trademarks of Apple Inc., registered in the U.S. and other countries.

Printed in Vietnam 5411 11562 00AD
Copyright © 2017 D&M Holdings Inc. All Rights Reserved.